



Natick Police Department
Incident Report

Page: 1
06/11/2018

Incident #: 18-669-OF
Call #: 18-9266

Date/Time Reported: 06/09/2018 0713
Report Date/Time: 06/10/2018 0557
Occurred Between: 06/09/2018 0530-06/09/2018 0800
Status: No Crime Involved

Reporting Officer: OFFICER JAMES ORDWAY
Approving Officer: SERGEANT ROBERT HOFFMAN

Signature: _____

Signature: _____



EVENTS (S)

LOCATION TYPE: Department/Discount Store Zone: Area A
TOTAL WINE AND MORE
321 SPEEN ST
NATICK MA 01760

1 SUSPICIOUS ACTIVITY

Ref: 18-669-OF

On 06/09/2018, at 0500 hours I was requested to make extra checks at the Cloverleaf Mall. It was discovered through on-line media that the Total Wine Store was promoting some type of an event that would be attracting a very large group of participants. During my checks I saw people arriving in the parking lot and lining up along the sidewalk of the store this line of people went along other store fronts reaching as far as the rear of the building near the Cloverleaf apartments. I estimate that there was well over four hundred people. While stopping by at approximately 0630 hours I spoke to one of the stores employees who stated that this event was for a chance to buy some rare Bourbon, that they would be handing out tickets to the first two hundred and fifty people and then they would draw a few of those tickets from the two hundred and fifty and those chosen would have the chance to purchase the alcohol. During my visit I noticed at the store entrance there was a DJ playing music and the store was providing coffee and donuts to the participants. My last visit there was at 0715 hours the store had given out the tickets and those that had a ticket were now standing about the parking lot waiting for the drawing of the few who would get the chance to make a purchase. I did photograph some of the party like atmosphere and will file them with this report.

Natick Police Department
Images Associated with 18-669-OF



Natick Police Department
Images Associated with 18-669-OF



2017 Town of Natick/Natick Service Council

PAYT Program – Year 4 Report

➤ Overview: 2016

- NSC received 2,750 small bags and 1,750 large bags
- NSC distributes PAYT bags to financially eligible clients

➤ Eligible Families/Bag Distribution:

- Families of (1-4) people – receive 3 small bags & 1 large bag monthly
- Families of (5+) people – receive 4 large bags monthly

➤ Trash Bag Distribution:

- Family size (1-4) = 936 Food Pantry visits
 - PAYT bag distribution = 2,750 small bags and 994 large bags
 - Note: We ran out of small bags and gave one large bag - in place of 3 small bags
- Family size (5+) = 172 Food Pantry visits
 - PAYT bag distribution = 746 large bags
- Total PAYT bags distributed
 - 2,750 small bags
 - 1,950 large bags

➤ Requested 2018 Donation:

- 2,750 small bags
- 1,950 large bags
- This recommendation accounts for the addition new clients



May 15, 2018

Re: MathWorks Apple Hill Campus Annual Berm Walks

Dear Neighbor:

Pursuant to the terms of the Special Permit issued for the MathWorks Apple Hill project and the direction of the Natick Planning Board, MathWorks will hold our annual berm walks with the Town and interested abutters to review status of the landscape buffer.

The schedule for the walks is as follows:

East Berm – Monday, June 11, 2018 at 5:00 PM

West Berm – Monday, June 18, 2018 at 5:00 PM

Those attending the June 11 walk should meet in the MathWorks parking lot near the east end of the East Parking Garage.

Those attending the June 18 walk should meet at the Route 9 end of Linden Street.

Should you have any questions, please contact me directly at 508-647-3212 or Craig.Lizotte@mathworks.com

Sincerely,

Craig Lizotte
MathWorks Inc.

CC: Elizabeth Haight, MathWorks
James Erickson, Town of Natick Community and Economic Development



MASSACHUSETTS BAY
TRANSPORTATION AUTHORITY

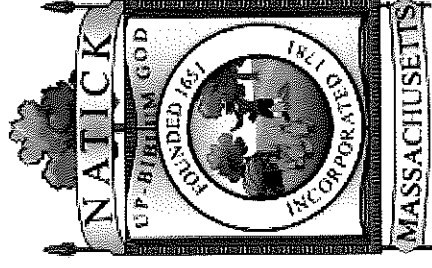

MBTA Natick Center Station Accessibility Improvements

PUBLIC MEETING

May 23, 2018

Project History

- Natick Center is the **busiest, fully inaccessible station** in the commuter rail system
- Accessible station a longstanding need, identified as a priority in **Natick 360** (2008)
- **Town Meeting** funded feasibility study/conceptual design (2012)
- BOS established **advisory committee** and hired **design consultant** (2013)
- **Conceptual design** delivered to MBTA (2014)
- Design funded in **MBTA Capital Plan** (2016)

Outreach

- Town/MBTA working group including Town staff
- MetroWest Regional Transit Authority (MWRTA)
- Natick DPW, Police and Fire
- Veterans Committee
- Natick Center Associates
- Abutters
- Natick Rotary
- Public Meetings (starting May 23)
- Town Committees:
 - Selectmen, Planning Board, Conservation, Historical, Design Review; more to come

Design Considerations

- Accessibility
- Tight project envelope
- Accommodate 3rd/center track
- Primarily walk/bike/RTA; limited parking
- Improve RTA connections
- Explore Cochrane Rail Trail Connection
- Improve traffic and pedestrian circulation, including distributed platform access
- Address drainage issues
- Respect Moran Square Park

Draft Project Timetable

- 30% design – June 2018
- 60% design – October 2018
- 100% design – March 2019
 - Public meetings at each milestone
- Project construction subject to capital funding
- Duration about 2 seasons

Purpose and Need

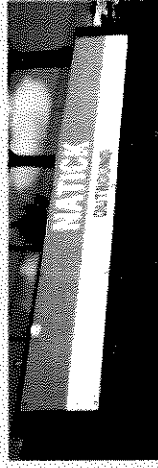

Natick Center MBTA Commuter Rail Station

FEASIBILITY STUDY AND CONCEPTUAL DESIGN FOR UPGRADES

Public Meeting
June 19, 2014

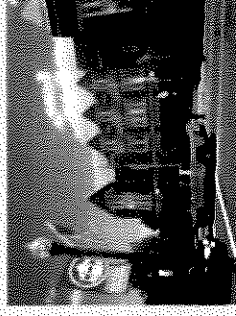

Natick Center Commuter Rail Station



The primary purpose of this Project is to support current and projected transit ridership in the Town of Natick by providing an upgraded MBTA Commuter Rail Station that integrates universal access in accordance with the Americans with Disabilities Act.

Study Area

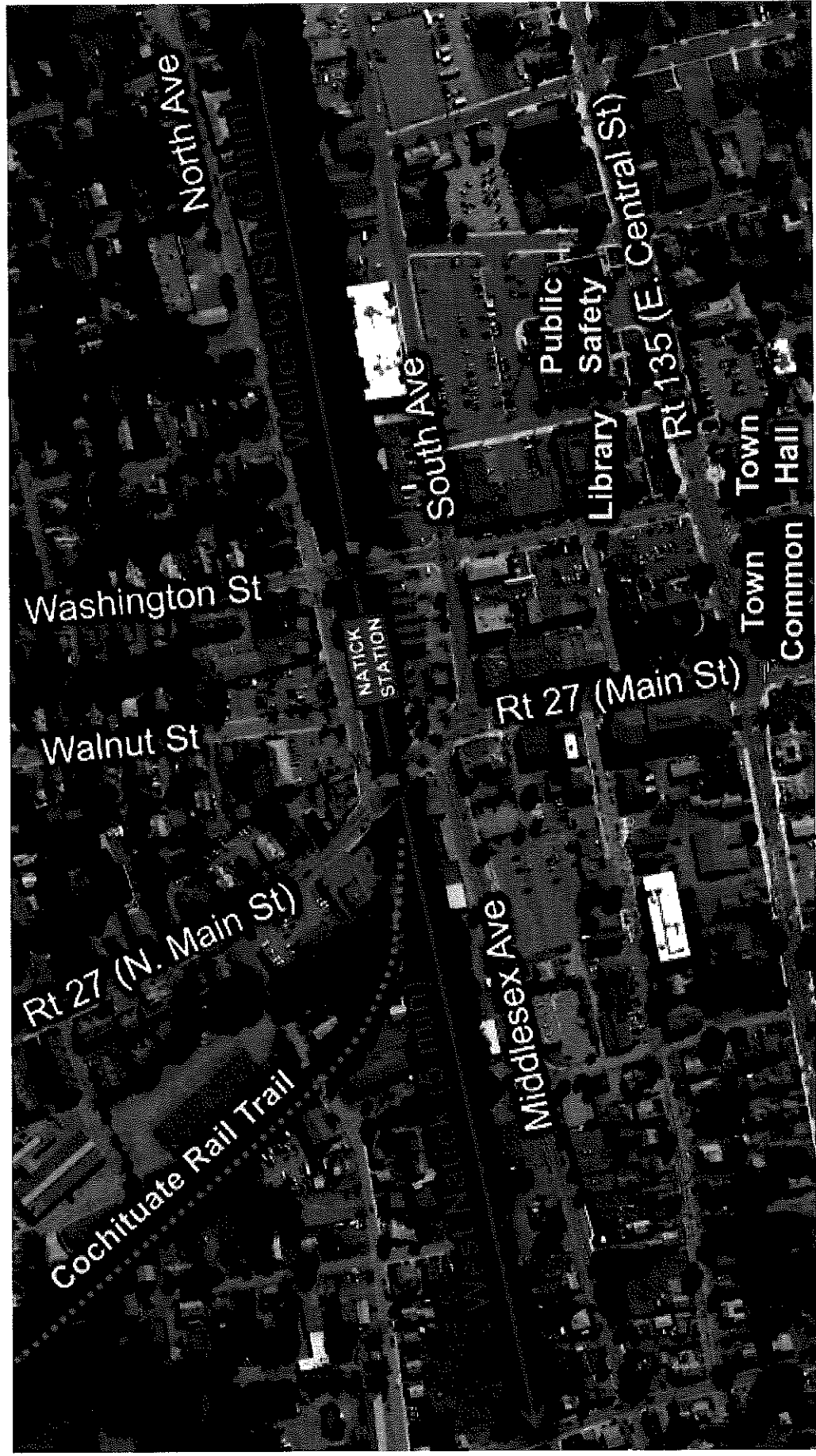

Existing Station



Existing Station



MBTA Natick Center Station Accessibility
Improvements Project

Existing Station



MBTA Natick Center Station Accessibility
Improvements Project

Existing Station

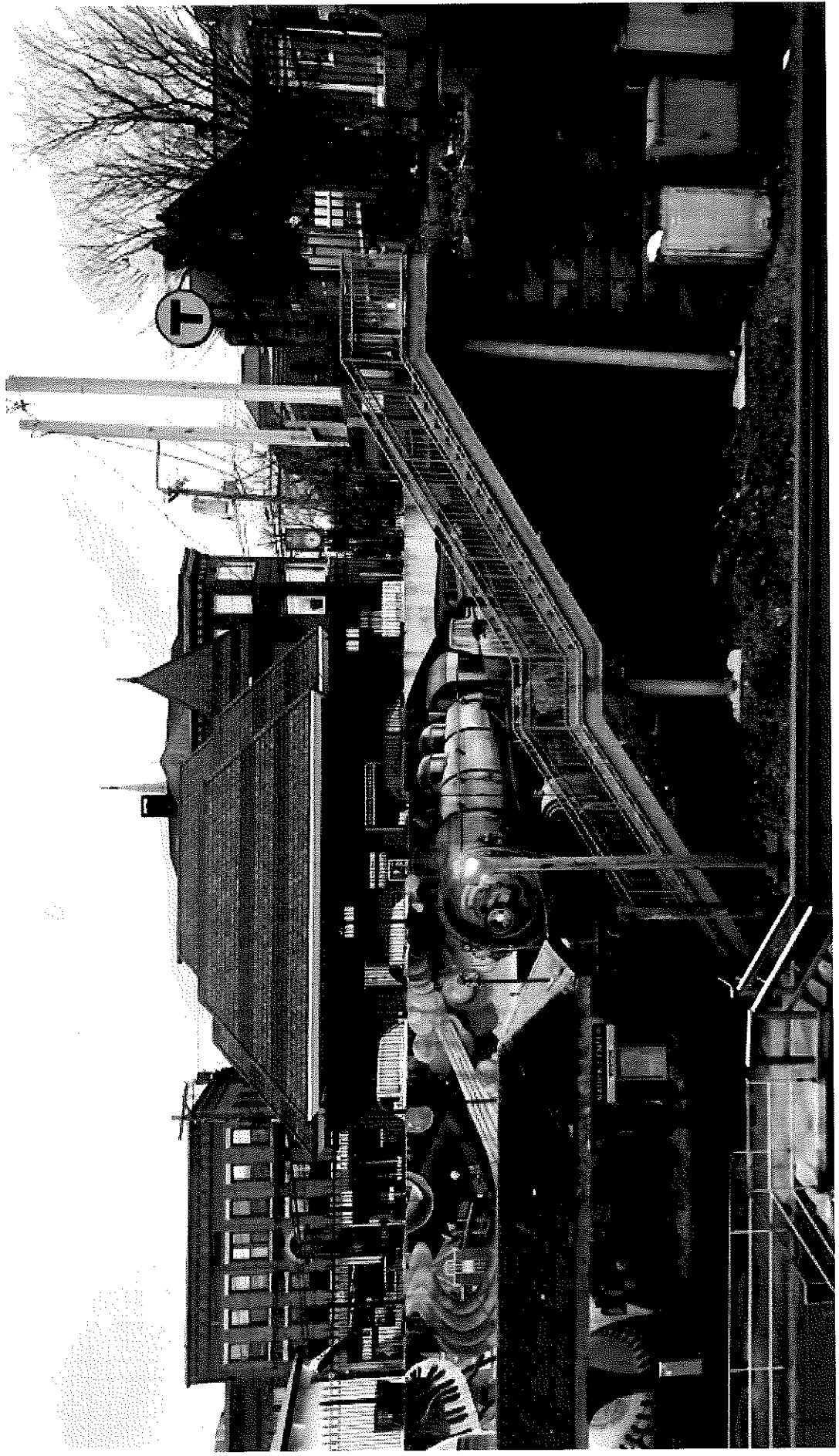

Station Area

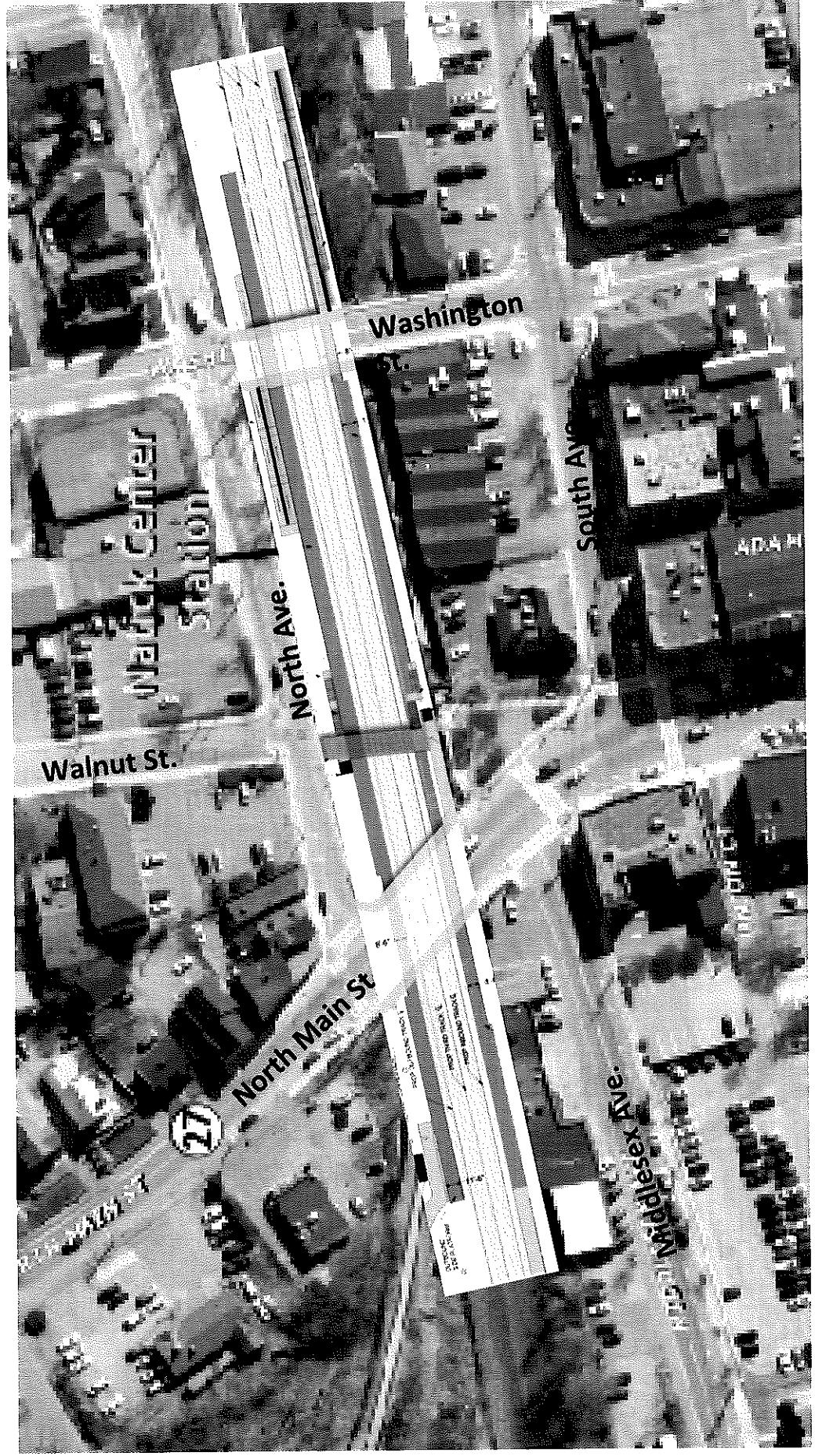

Station Layout Plan (west end)

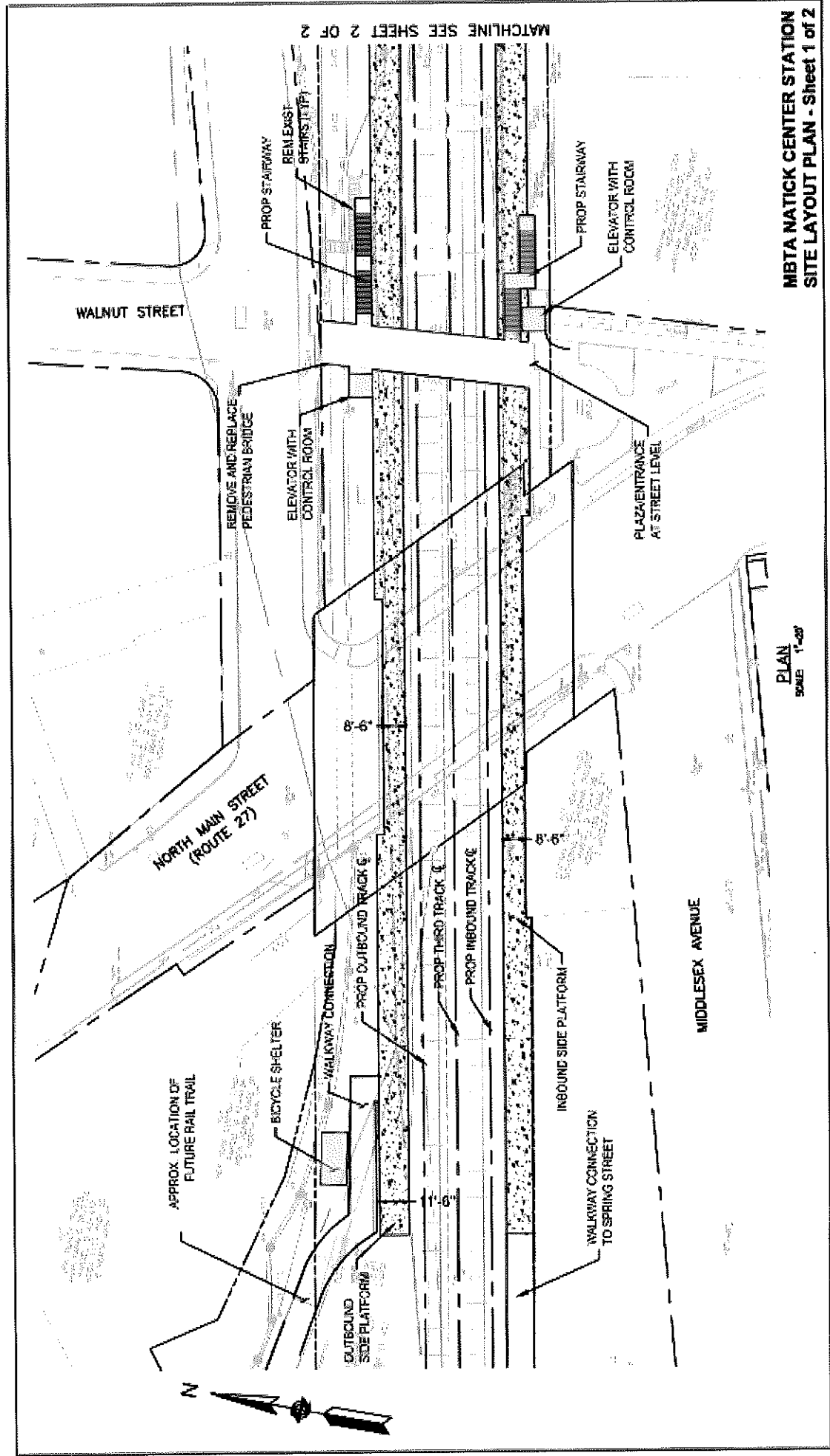

Station Layout Plan (east end)

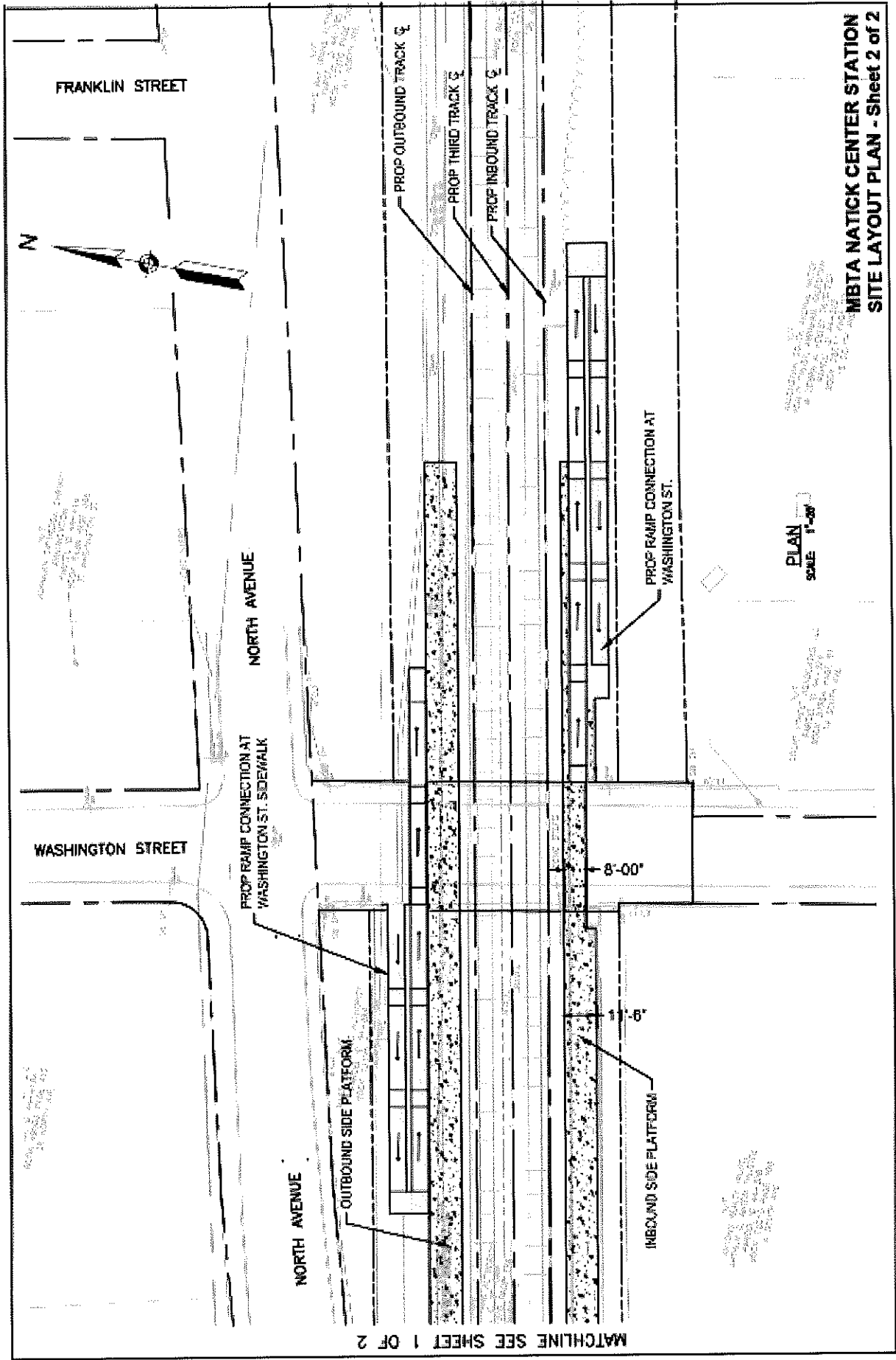

Commuter Rail Station Features

- High Level Platforms
- Tactile Warning
- Canopies
- Wayfinding Signs
- Benches
- VMS
- Lighting
- Police Call Box
- Security Cameras



Supplemental Features



- Elevators and Stairways
- Ramps and Sloped Walkways
- Bicycle Shelters

Veterans Memorial Park – Moran Square

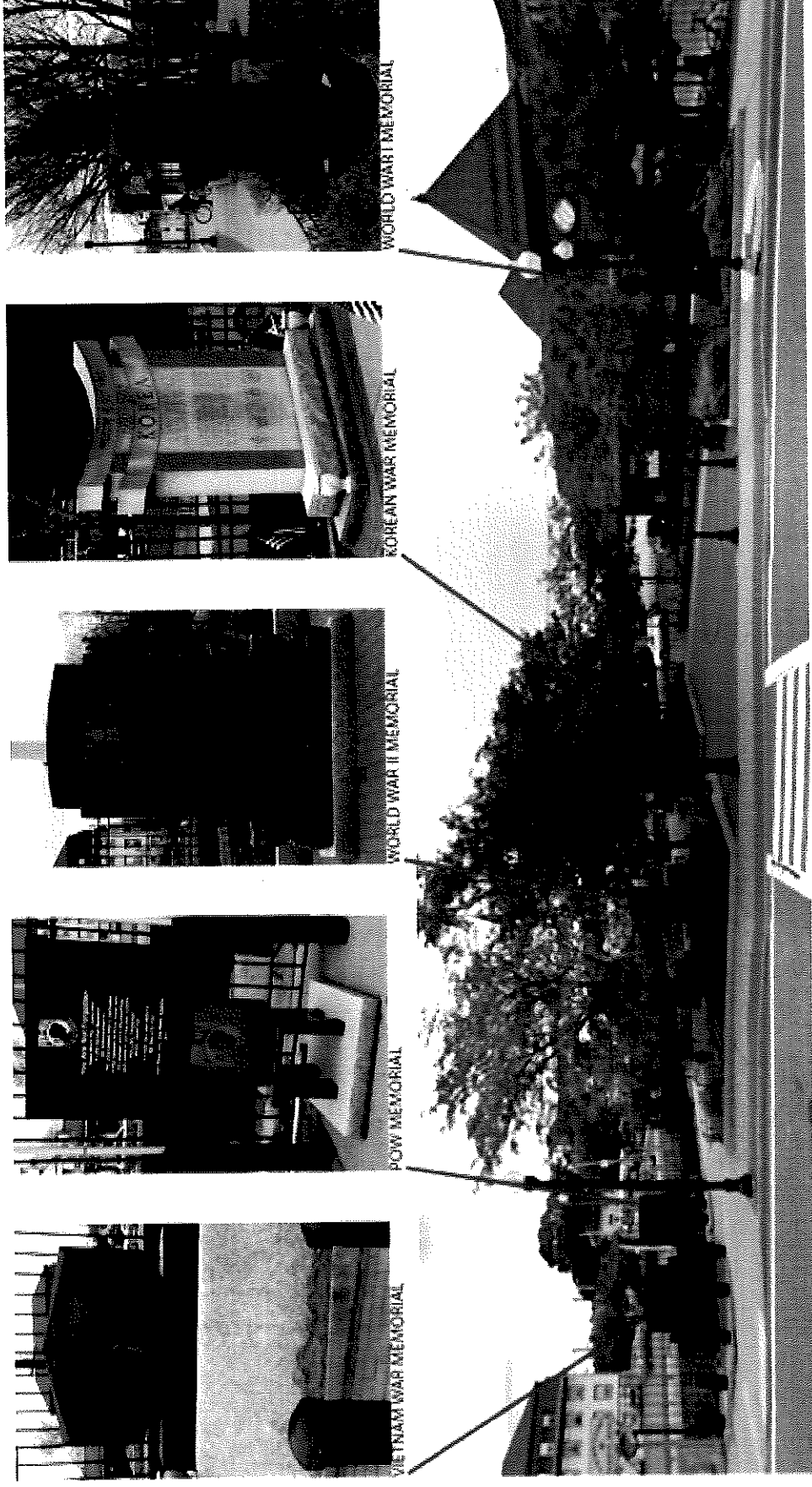
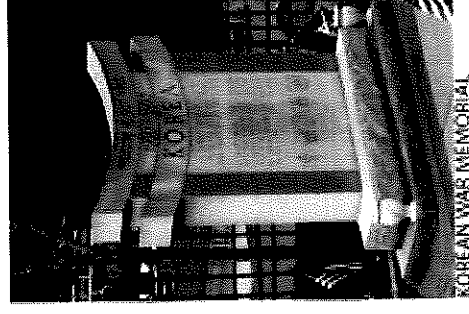
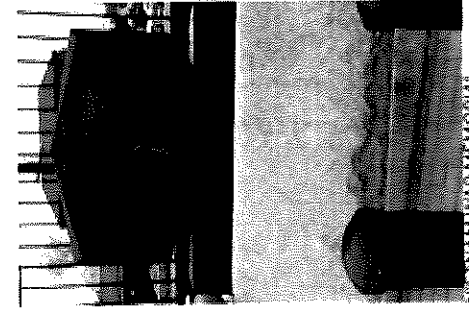

Circulation

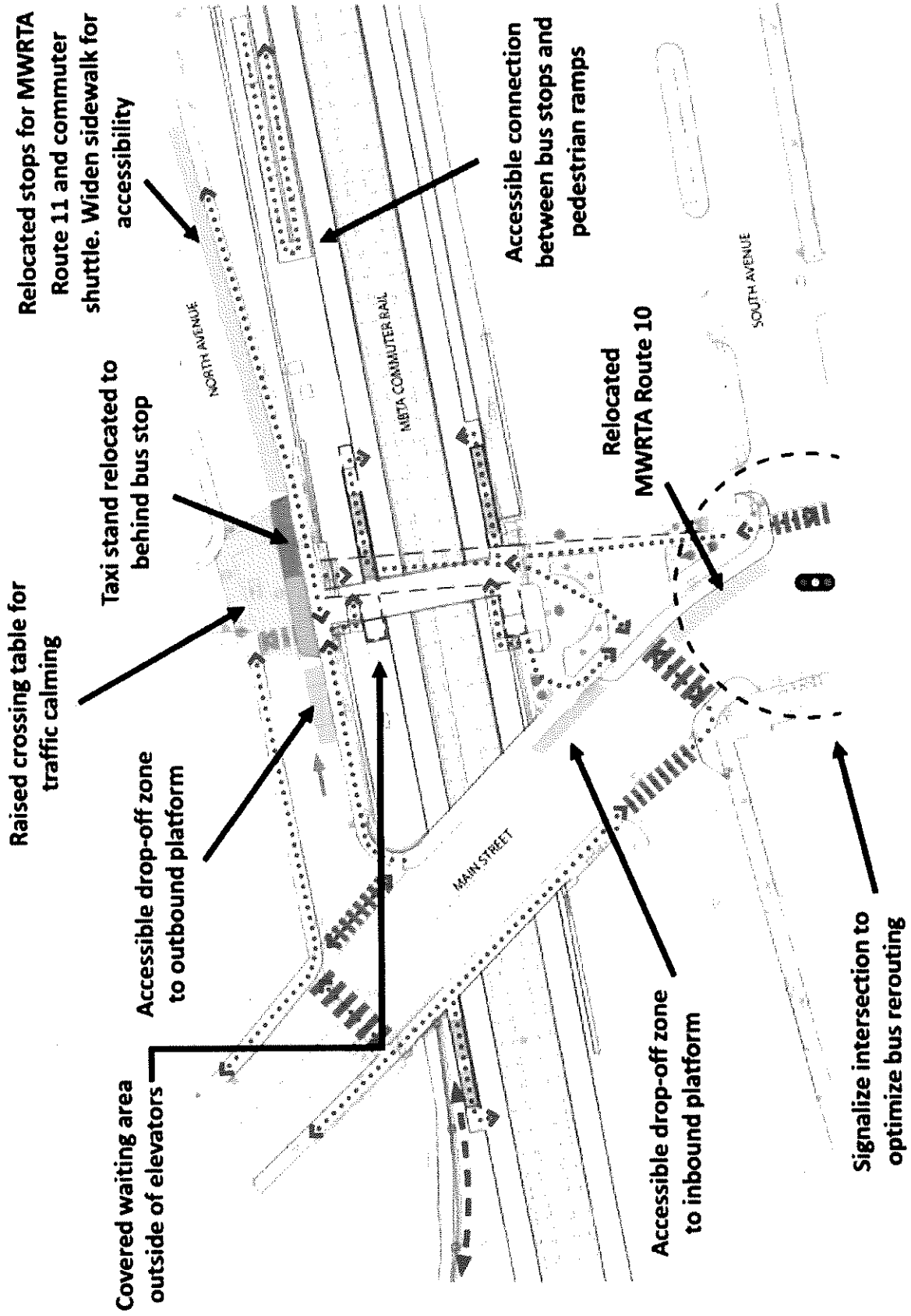

Pedestrian Improvements

- Raised crossing table with crosswalks
- Prioritizes pedestrian movements across North Avenue
- Increases safety by promoting traffic calming & reduced vehicle speed

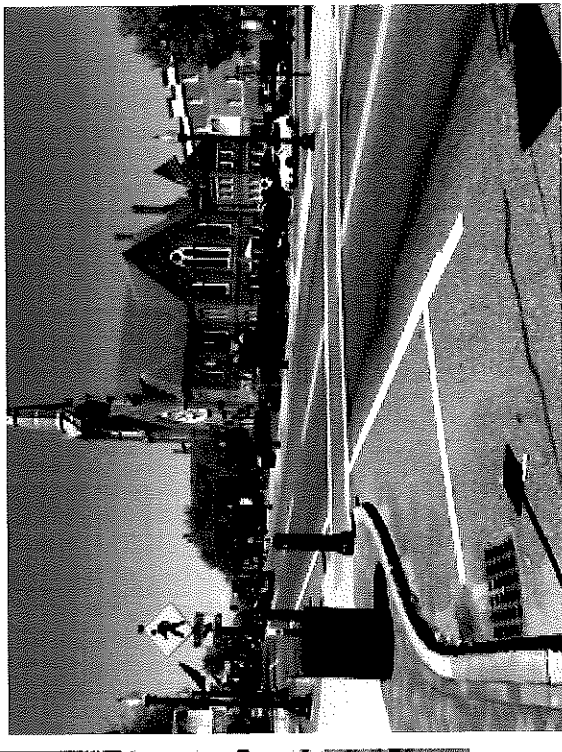
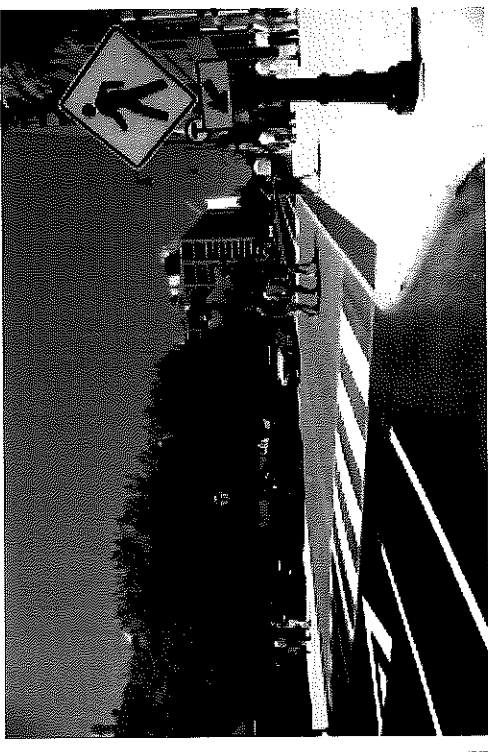

Bus Stop & Traffic Improvements

Today:

- Unclear curb uses
- Bus blocks travel lane
- Non-Compliant Sidewalks



Future:

- Designated bus stop
- Accessible Sidewalks
- Clear Path for vehicles

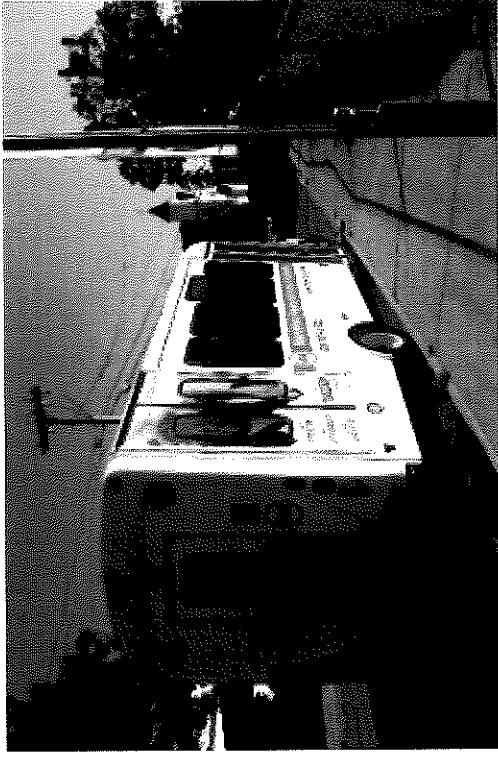

Accessible Bus Stop Layout & Elements

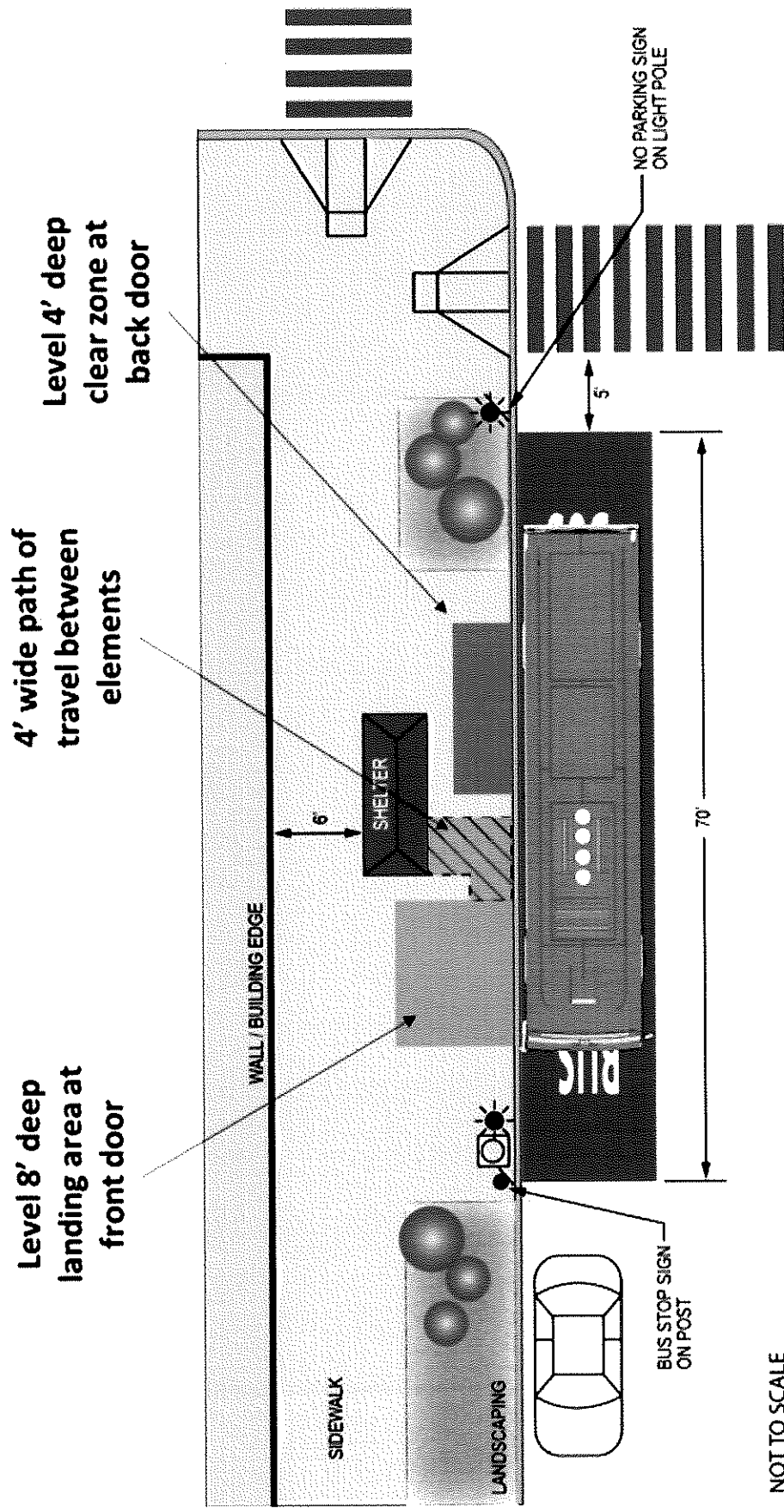

NOT TO SCALE

Source: Rhode Island Bus Stop Design Guidelines

Circulation

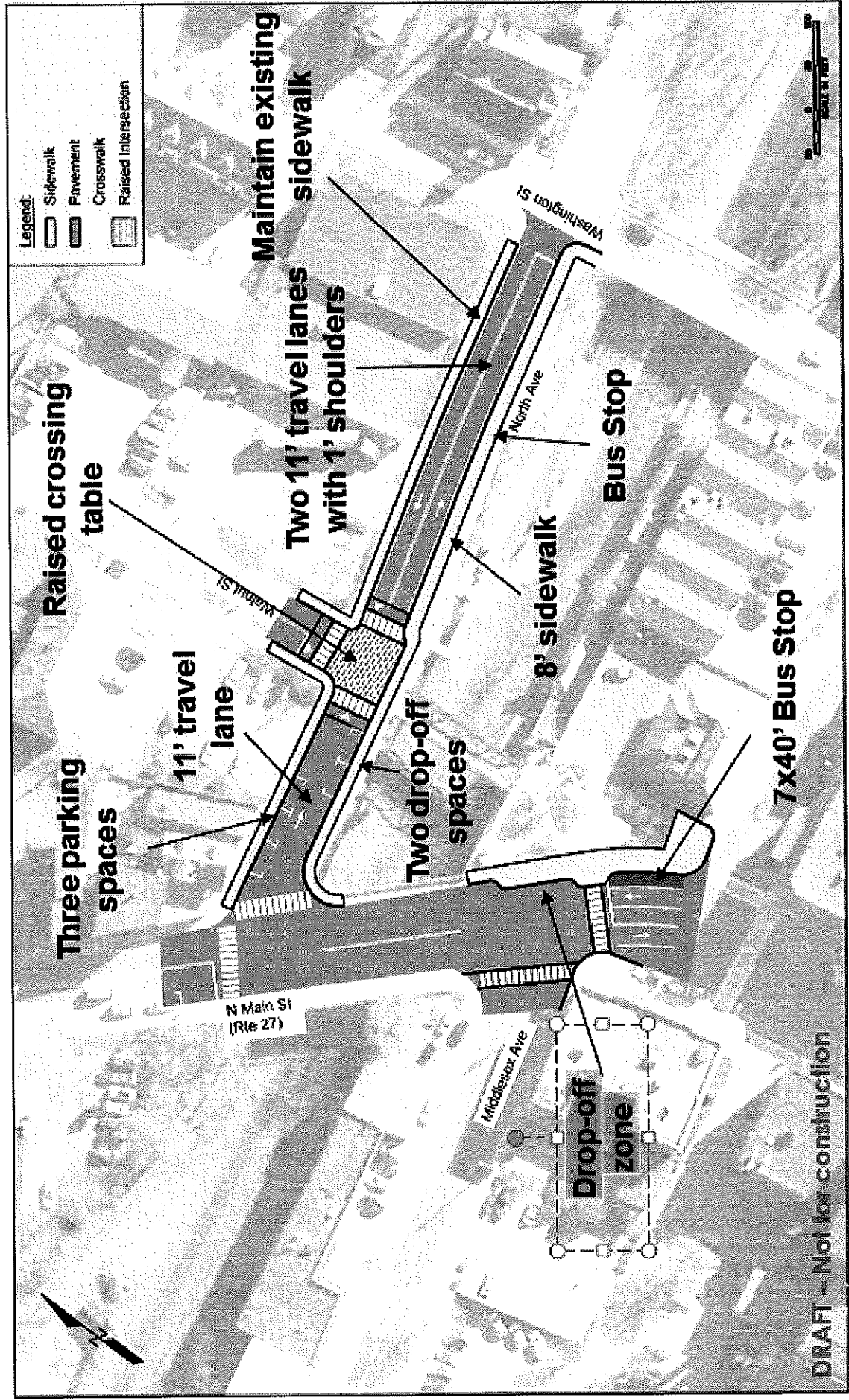

Potential one-way Option

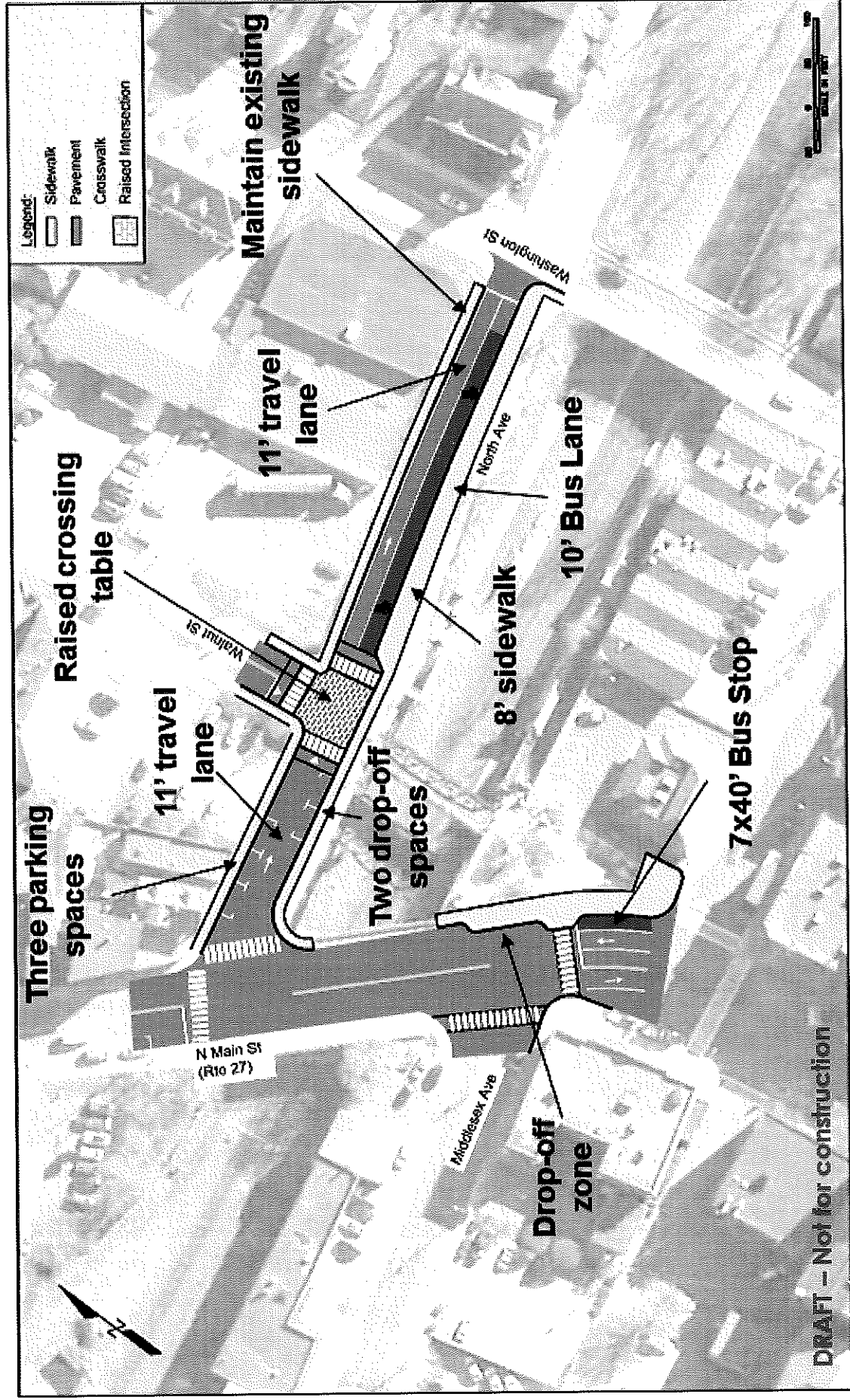

Comments and Questions

MBTA Natick Center Station Accessibility Improvements



+



**MASSACHUSETTS BAY
TRANSPORTATION AUTHORITY**

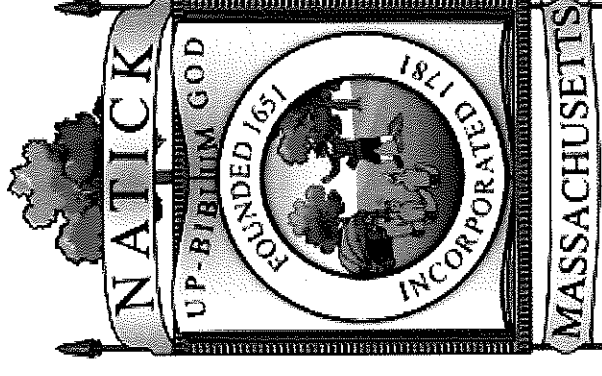

Temporary email addresses:

mbta@natickma.org

francis.astone@aecom.com

Jnolan@citypointpartners.com