

EVERSOURCE 157 Cordaville Road Southborough, MA 01772

July 9, 2018

Town of Natick
Board of Selectmen
13 East Central St
Natick, MA 01760

Please approve for Grant Of Location purposes the following plan:

To install 30' of 2.00" plastic gas main on Schaller St. between #19 Schaller St and the Wellesley Town Line as a main extension.

Respectfully,

Mark Kish, PE
Fulfillment Supervisor
Gas-Planning and Scheduling
Eversource Energy
339-987-8372

PETITION FOR GRANT OF LOCATION

To the Town of Natick Board of Selectmen, Natick, Massachusetts.

Eversource Energy requests permission to lay and maintain underground gas main and service pipelines under the surface of the following public way or private way:

Plan name: Schaller St., Natick -- Grant Of Location - Page 1 of 1

To install 30' of 2.00" plastic main on Schaller St. between #19 Schaller St and the Wellesley T.L.

Also, for permission to lay and maintain underground pipelines, regulator pits in the above or intersecting public ways for purpose of making connections with such pipelines and buildings as it may desire for distributing purposes.

Date: 07/09/2018

Mark Kish, PE
Fulfillment Supervisor
Gas-Planning and Scheduling
Eversource Energy
339-987-8372

ORDER FOR GRANT OF LOCATION

The Board of Selectmen of the Town of Natick, Massachusetts.
ORDERED

That permission be and hereby is granted to Eversource Energy to lay and maintain underground pipelines and regulator pits, under the surface of the following public ways as requested in petition(s) of said company dated as listed below:

To install 30' of 2.00" plastic gas main on Schaller St. between #19 Schaller St and the Wellesley T.L.

Amy K. Mistrot, Chairman

Susan G. Salamoff, Vice Chairman

Michael J. Hickey, Jr., Clerk

Richard P. Jennett, Jr.

Jonathan Freedman

I hereby certify that the foregoing is a true copy of a location order, and certificate of hearing with notice adopted by the Board of Selectmen of the Town of Natick, Massachusetts, on the _____ day of _____ and recorded with the records of location orders of said Town, Book _____, Page _____. This certified copy is made under the provisions of Chapter 166 of General Laws and any additions thereto or amendments thereof.

Attest:

Town Clerk

TYPICAL TRENCH DETAIL

NOT TO SCALE

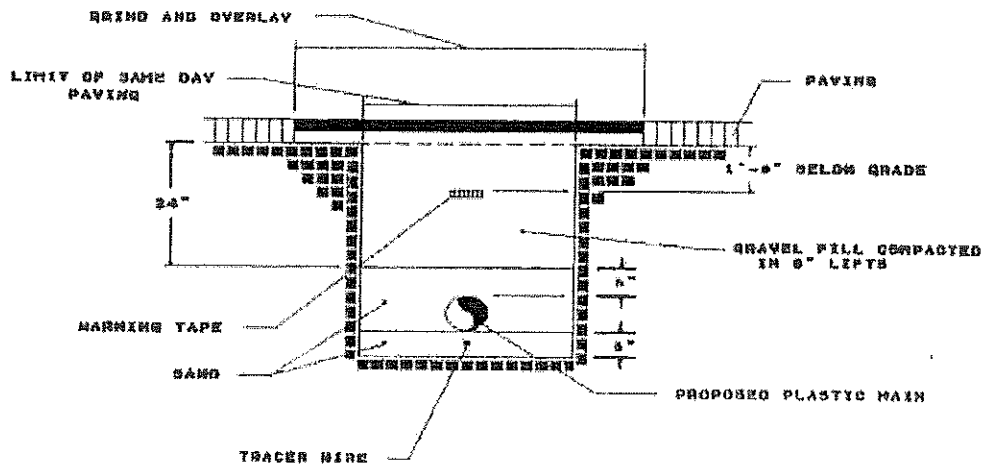

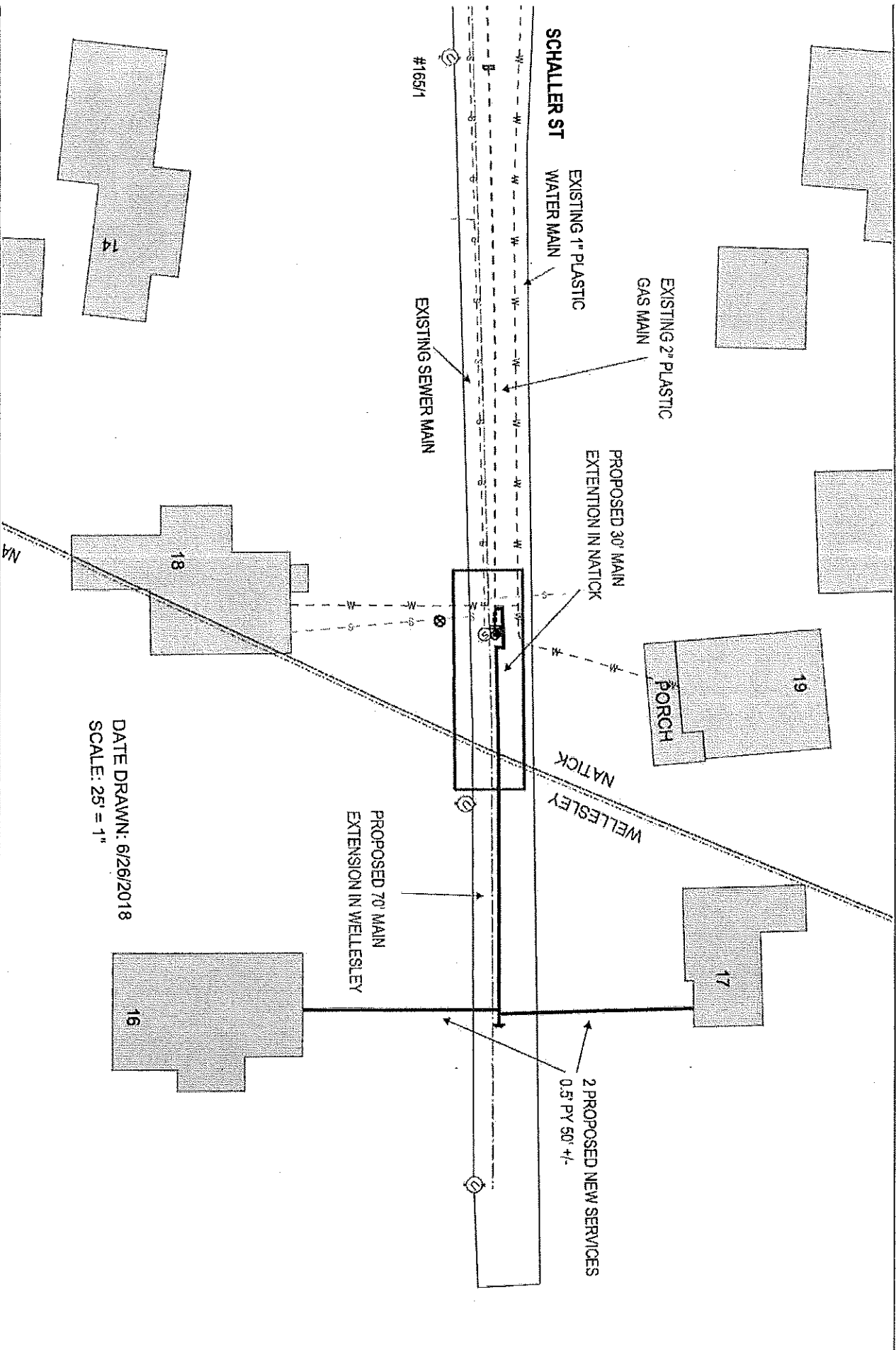

DATE DRAWN: 6/26/2018
SCALE: 25' = 1"

EVERSOURCE

EVERSOURCE MA GAS
Wellesley, MA 02159
Phone 1-800-592-2000

MASS LAW

Requires 72 hours advance notice of excavation before opening by Applicant

Call Dig-Safe: 811

IMPORTANT - DO NOT SCALE

This drawing provides approximate locations only and all facility information may not be shown. EVERSOURCE MA GAS is to have specific field information identified on the ground. EVERSOURCE MA GAS is not responsible for any damage to any person or property on the location shown on this map. All excavations shall require the presence of any underground may be marked.

Address: **Grant of Location**

City/Town: **Schaller St. Natick**