

# **MBTA Natick Center Station Accessibility Improvements**

**PUBLIC MEETING**  
**February 13, 2019**



**Massachusetts Bay  
Transportation Authority**

# Overview

- Purpose of the Public Meeting is to inform the public of the Design, Construction, Schedule and Next Steps of the Project, and to seek feedback
- Natick Center Station is the busiest commuter rail station on the MBTA System that is not fully accessible
- A Feasibility Study was completed in 2014 recommending an upgraded MBTA Commuter Rail Station that integrates universal access in accordance with the ADA
- Extensive Outreach Process
- Regulatory Permit Process underway (Section 106, WPA)
- Project advancing towards 90% Design

# Outreach

- Town/MBTA Working Group
- MetroWest Regional Transit Authority (MWRTA)
- Natick DPW, Police and Fire
- Natick Center Associates
- Veterans Committee
- Rotary Club
- Abutters
- Public Meetings
- Other Town Committees:
  - ❑ Board of Selectmen, Planning Board, Design Review Board, Historical Commission, Conservation Commission

# Design Considerations

- Improve Accessibility
- Improve traffic and pedestrian circulation
- Maintain Commuter Rail Operations during construction
- Coordinate with MetroWest Regional Transit Authority
- Accommodate potential future Third Track
- Address drainage & flooding issues thru station area
- Coordinate with Cochituate Rail Trail Project
- Look at opportunities to enhance bicycle parking
- Continued coordination with stakeholders



# Project Area

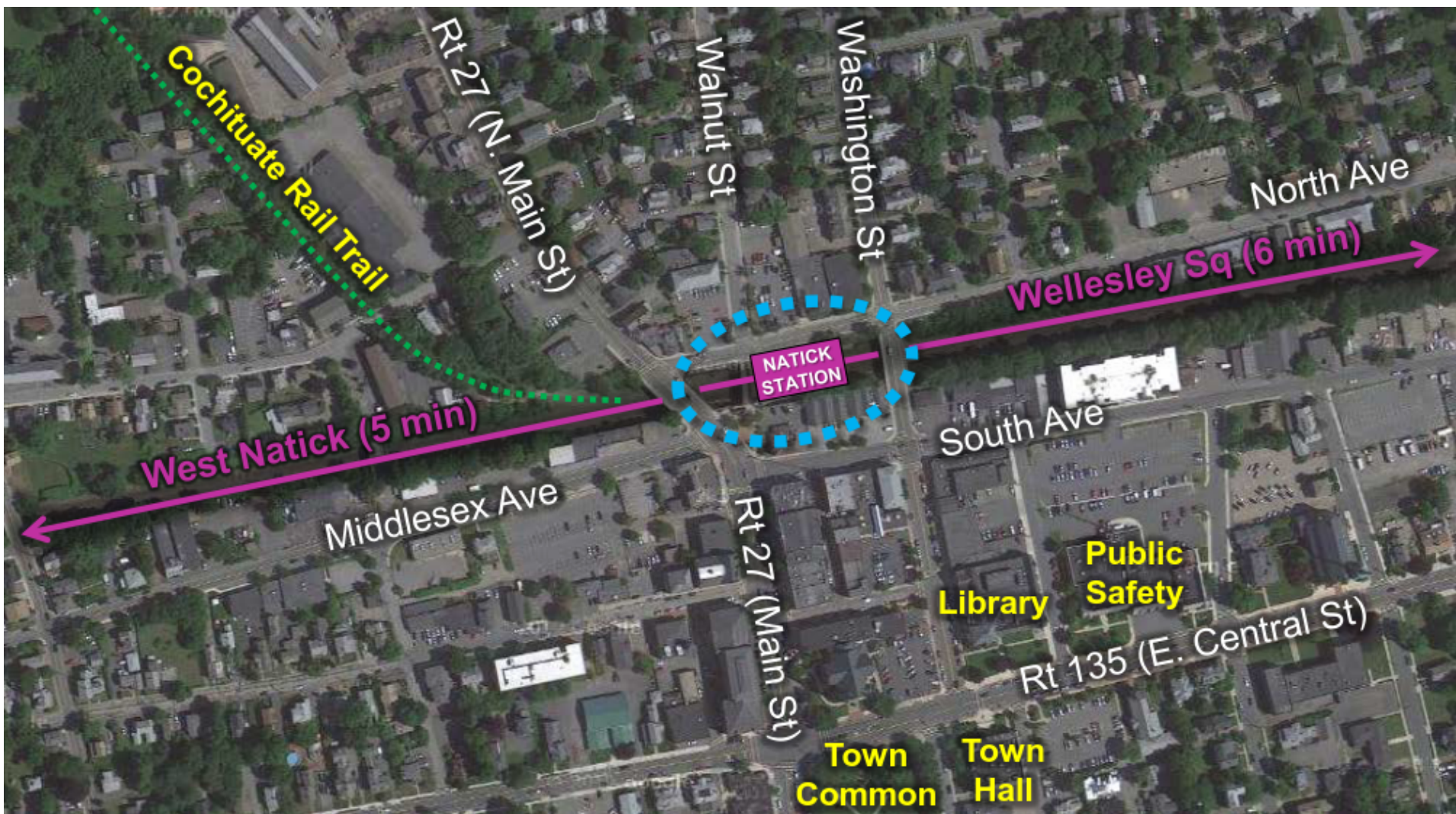



# Existing Conditions



**VIEW LOOKING EAST TO  
WASHINGTON ST. BRIDGE**



**VIEW LOOKING WEST TO NORTH  
MAIN ST. & PEDESTRIAN BRIDGE**



# Project Elements – Site



# Project Elements

- New High-Level Passenger Platforms
- Provide new Station Canopies
- Replace the Pedestrian Bridge
- Replace Stairs to Station platforms
- Incorporate Elevators
- Provide Secondary Station Access from Washington St
- Improve Passenger Safety, Comfort & Security
  - Coverage for Stairs and Ramps
  - Extensive Lighting upgrades
  - Wayfinding Signage
  - CCTV Cameras
  - Passenger Assistance Telephones



# Proposed Station – Birds Eye View

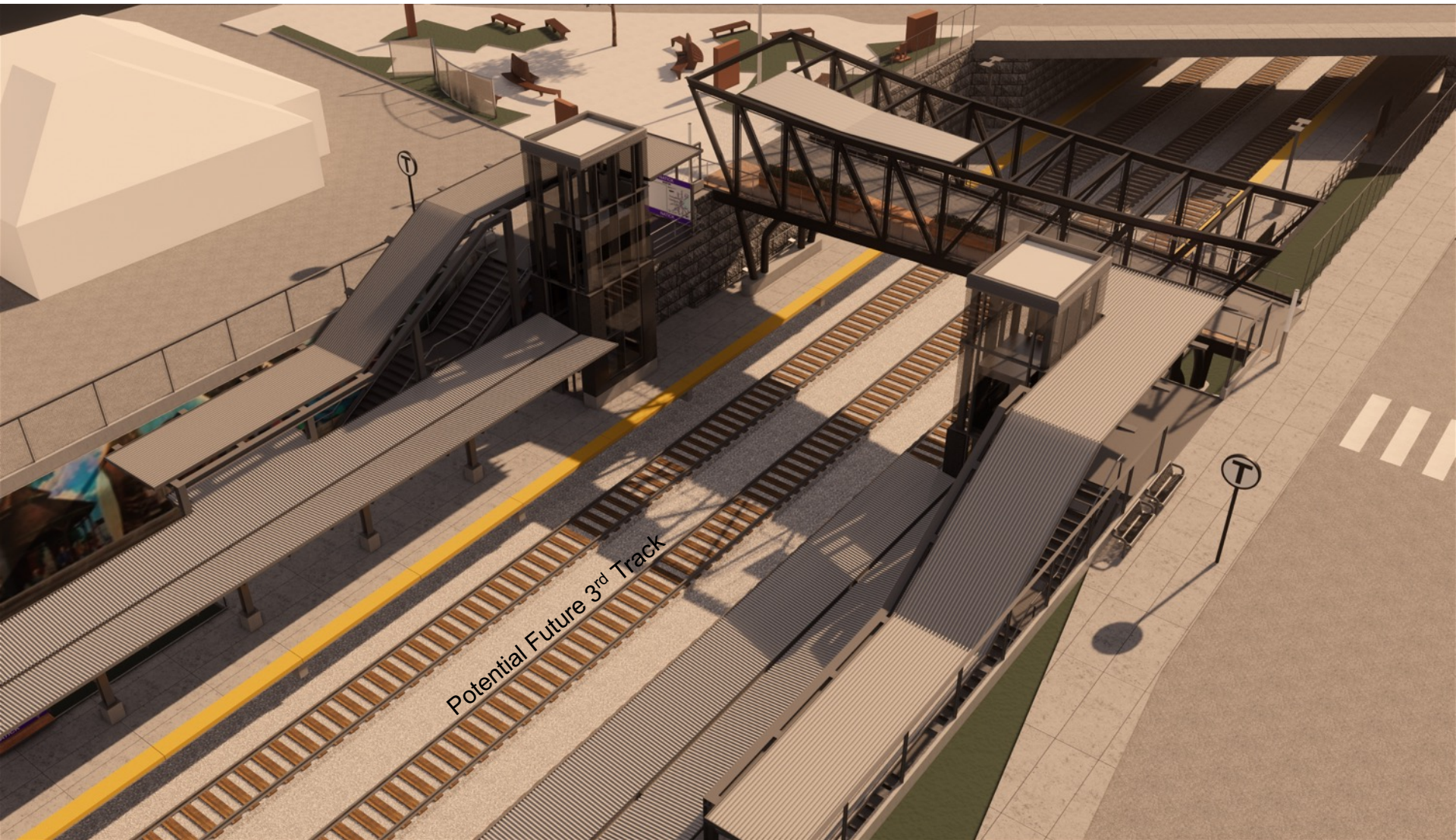



# Proposed Station – Platform View

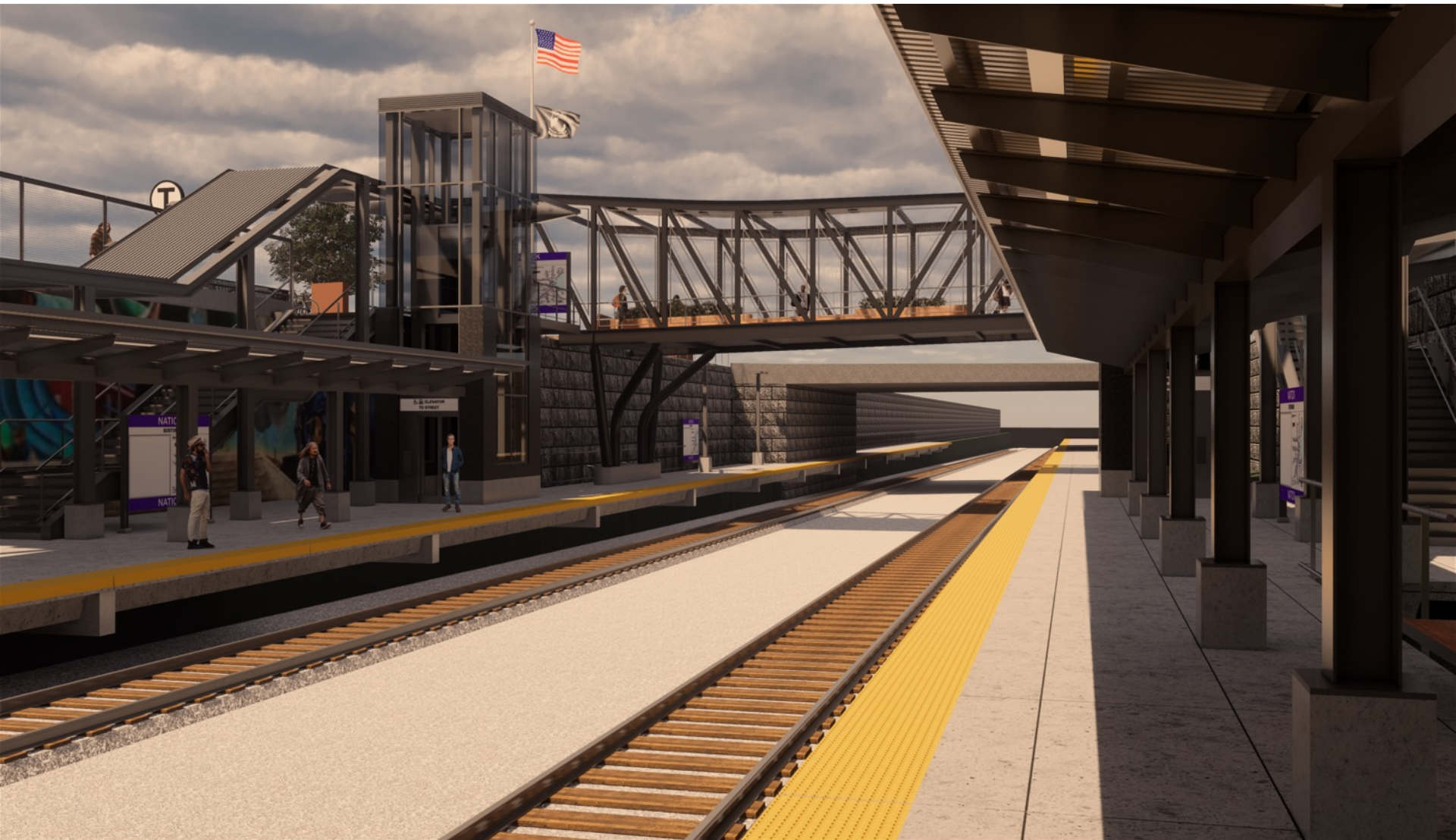



# Proposed Station – Pedestrian Bridge

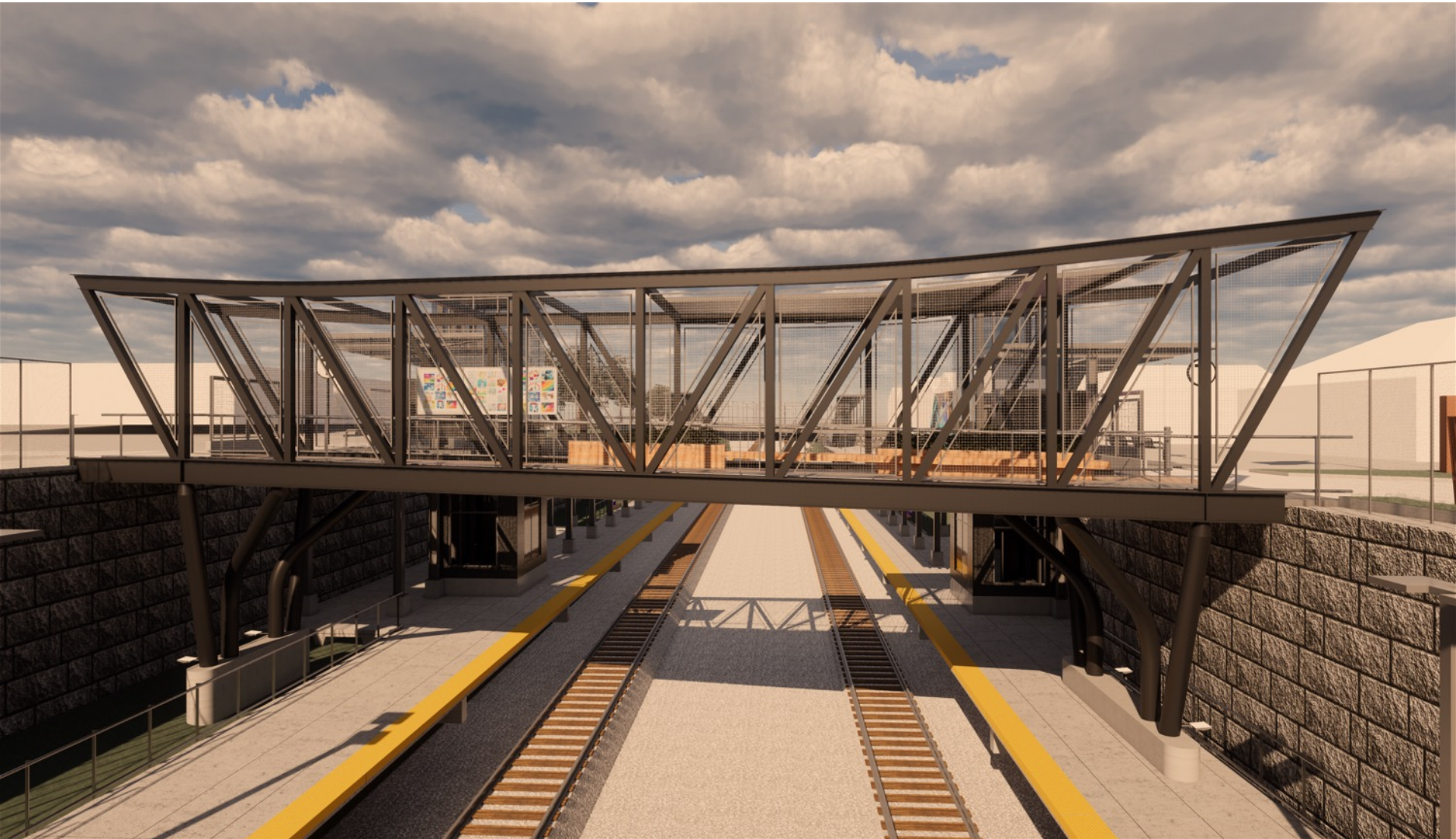



# Ped Bridge view from North Ave – Before





# Ped Bridge view from North Ave - After





# Ped Bridge view from South - Before





# Ped Bridge view from South - After





# Pedestrian Bridge





# Pedestrian Bridge – Night View



# Station Elements – View from Platform

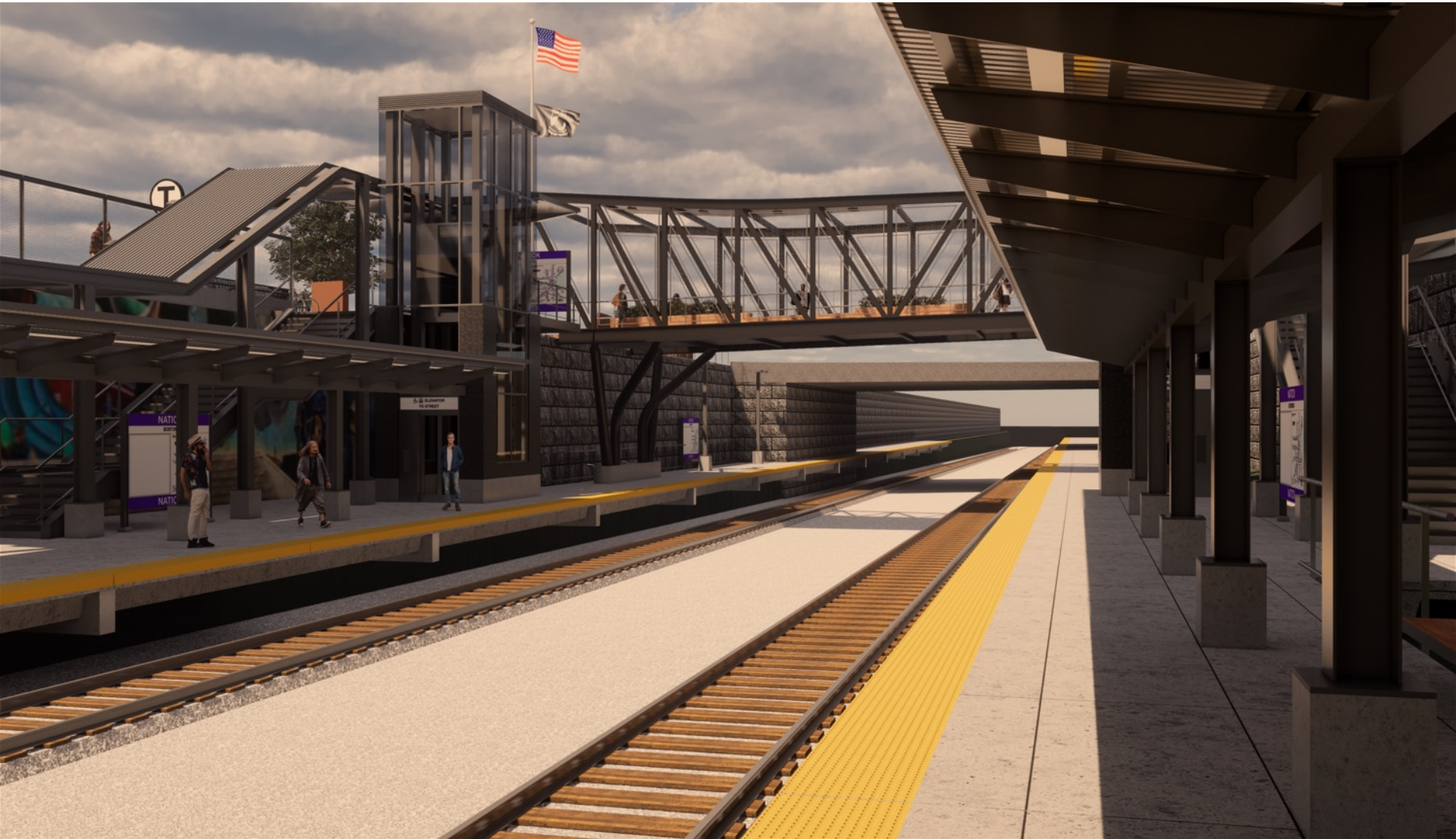



# Outbound Station Platform





# Inbound Station Platform

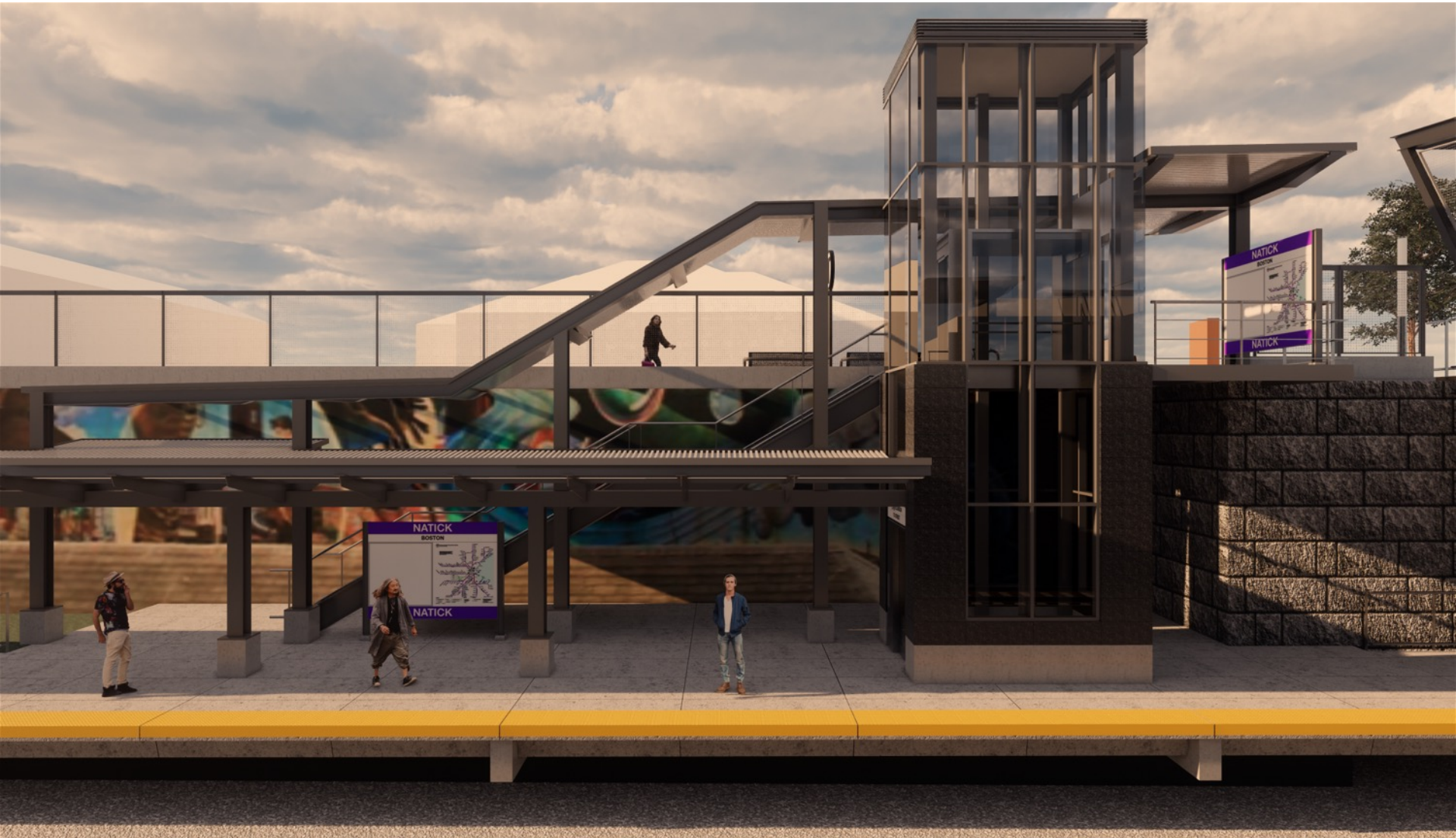



# Station Entrance at Washington St.

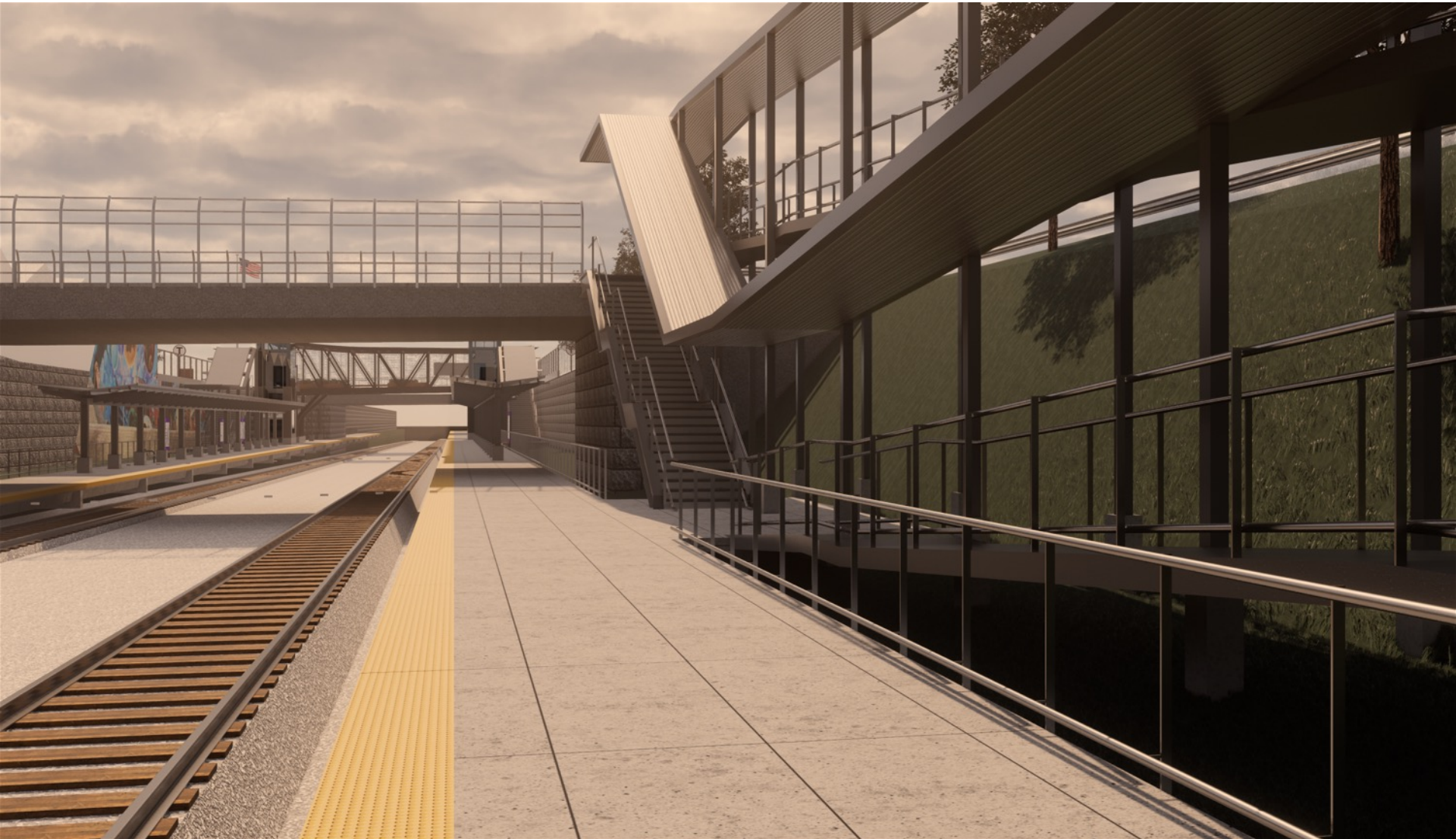

# Project Schedule

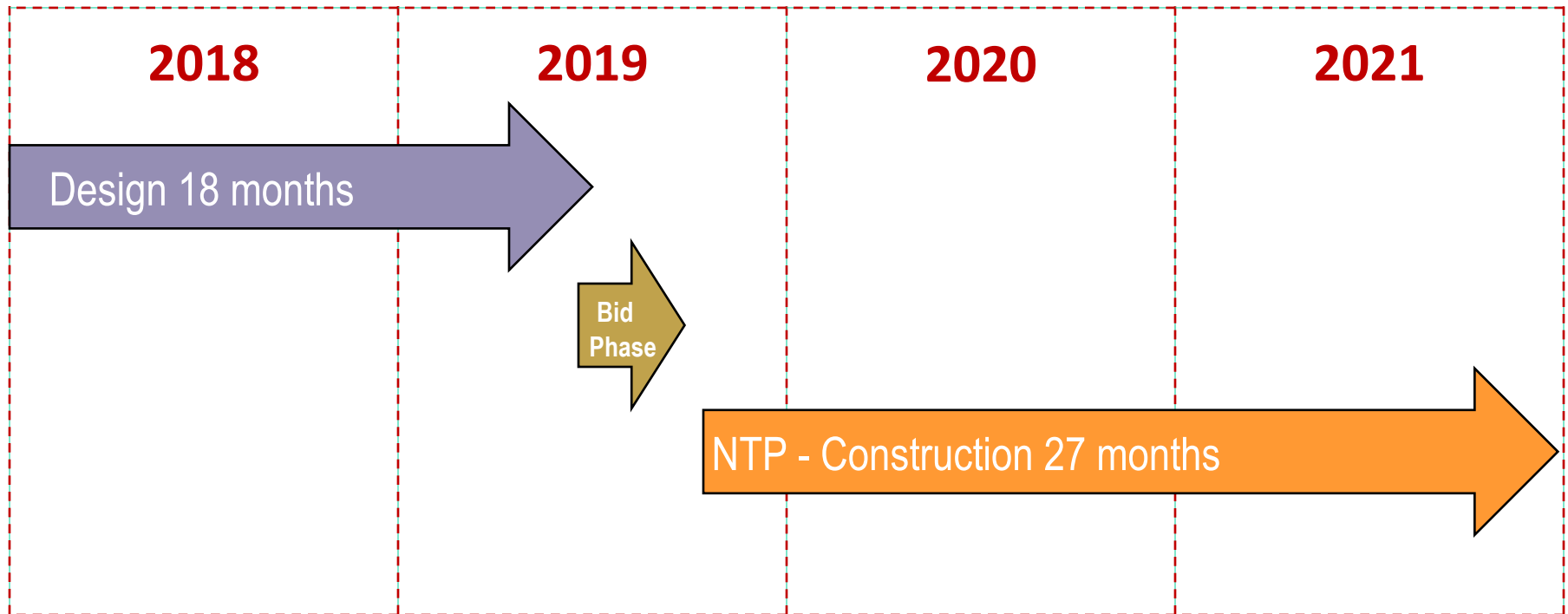

- Advertise for Construction: Summer 2019
- Anticipated Contractor Notice to Proceed: Fall 2019

*\*Dates contingent on receiving additional funding for construction through the FY20-FY24 CIP Approval Process*

# **MBTA Natick Center Station Accessibility Improvements**

**PUBLIC MEETING**

**February 13, 2019**

## **QUESTIONS & COMMENTS**



**Massachusetts Bay  
Transportation Authority**