

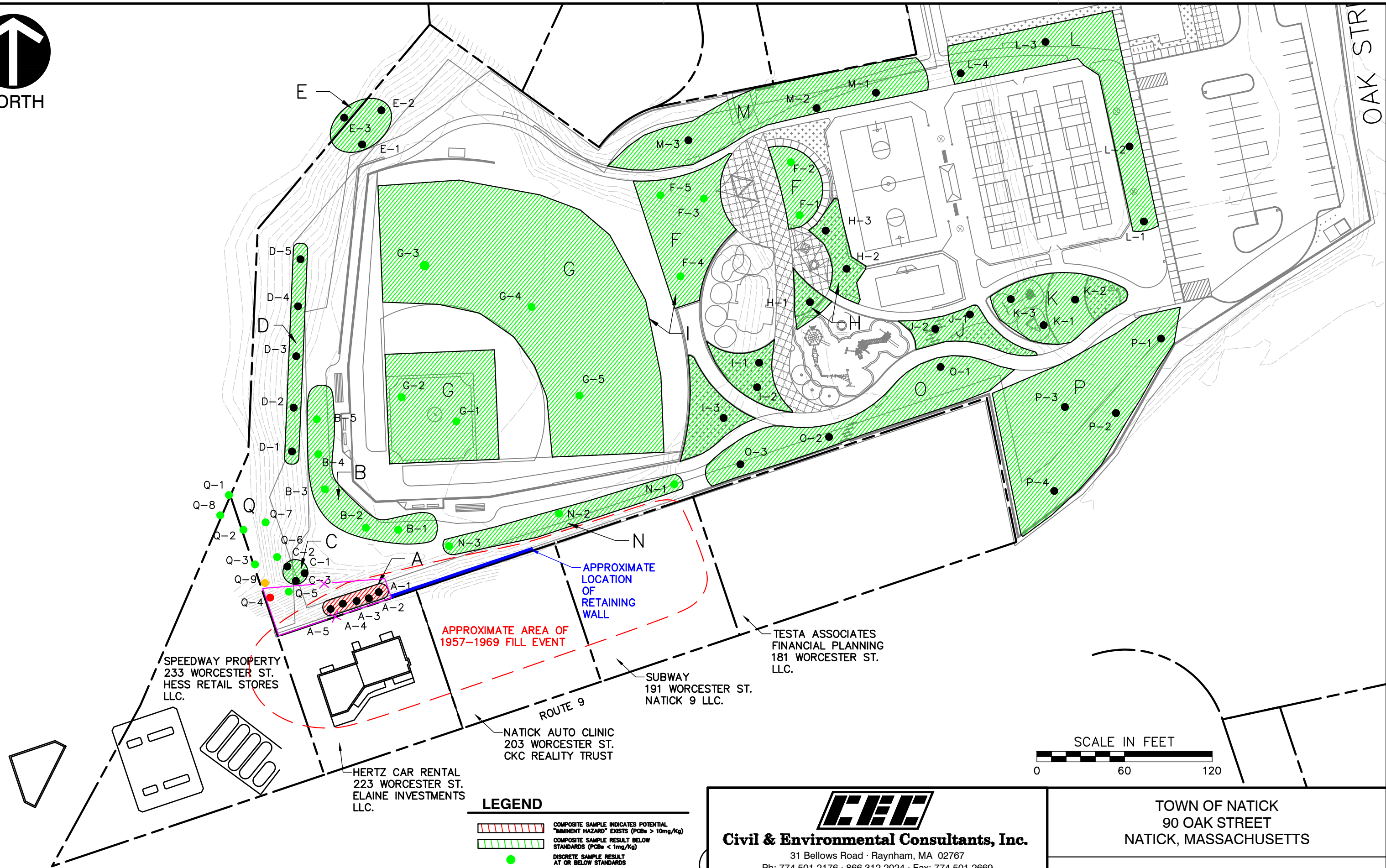

P:\2019\195-909-CADD\DWG\195-909-11x17\_Setup.dwg[FIGURE 2] LS: (12/31/2019 - mvarao) - LP: 12/31/2019 10:03 AM



**LEGEND**

- COMPOSITE SAMPLE INDICATES POTENTIAL "IMMINENT HAZARD" EXISTS (PCBs > 10mg/Kg)
- COMPOSITE SAMPLE RESULT BELOW STANDARDS (PCBs < 1mg/Kg)
- DISCRETE SAMPLE RESULT AT OR BELOW STANDARDS
- DISCRETE SAMPLE ON HOLD (NOT YET ANALYZED)
- DISCRETE SAMPLE RESULT INDICATES POTENTIAL "IMMINENT HAZARD" (PCBs > 10mg/Kg)
- DISCRETE SAMPLE RESULT FOR PCBs < 10mg/Kg BUT > 1mg/Kg



**Civil & Environmental Consultants, Inc.**

31 Bellows Road · Raynham, MA 02767  
Ph: 774.501.2176 · 866.312.2024 · Fax: 774.501.2669  
www.cecinc.com

DRAWN BY:	MPV	CHECKED BY:	MOC
DATE:	DECEMBER 2019	DWG SCALE:	1"=60'

TOWN OF NATICK 90 OAK STREET NATICK, MASSACHUSETTS	
SITE PLAN	
APPROVED BY:	MOC
PROJECT NO:	195-909
FIGURE NO.:	2



P:\2019\195-909-CADD\DWG\195-909-11x17\_Setup.dwg[FIGURE 3] LS:(12/31/2019 - mvarao) - LP: 12/31/2019 10:01 AM

SPEEDWAY PROPERTY  
233 WORCESTER ST.  
HESS RETAIL STORES  
LLC.

LEGEND

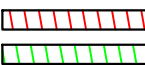

COMPOSITE SAMPLE INDICATES POTENTIAL  
"IMMEDIATE HAZARD" EXISTS (PCBs > 10mg/Kg)  
COMPOSITE SAMPLE RESULT BELOW  
STANDARDS (PCBs < 1mg/Kg)  
DISCRETE SAMPLE RESULT  
AT OR BELOW STANDARDS  
DISCRETE SAMPLE ON HOLD  
(NOT YET ANALYZED)  
DISCRETE SAMPLE RESULT INDICATES POTENTIAL  
"IMMEDIATE HAZARD" (PCBs > 10mg/Kg)  
DISCRETE SAMPLE RESULT FOR PCBs <  
10mg/Kg BUT > 1mg/Kg

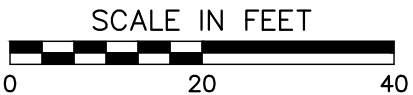

**C&E**  
**Civil & Environmental Consultants, Inc.**  
31 Bellows Road · Raynham, MA 02767  
Ph: 774.501.2176 · 866.312.2024 · Fax: 774.501.2669  
www.cecinc.com

TOWN OF NATICK  
90 OAK STREET  
NATICK, MASSACHUSETTS

FENCE LOCATION PLAN

DRAWN BY:	MPV	CHECKED BY:	MOC	APPROVED BY:	MOC	FIGURE NO.:
DATE:	DECEMBER 2019	DWG SCALE:	1"=20'	PROJECT NO:	195-909	