

REFERENCES:  
MIDDLESEX COUNTY REGISTRY OF DEEDS  
PLAN BOOK 212 PLAN 45  
PLAN 229 OF 1969  
PLAN 31 OF 1976  
PLAN 1553 OF 1986  
MASSACHUSETTS HIGHWAY DEPARTMENT  
S.H.L.O. #2829 (1931)  
S.H.L.O. #4321 (1936)  
S.H.L.O. #8170 (2012)

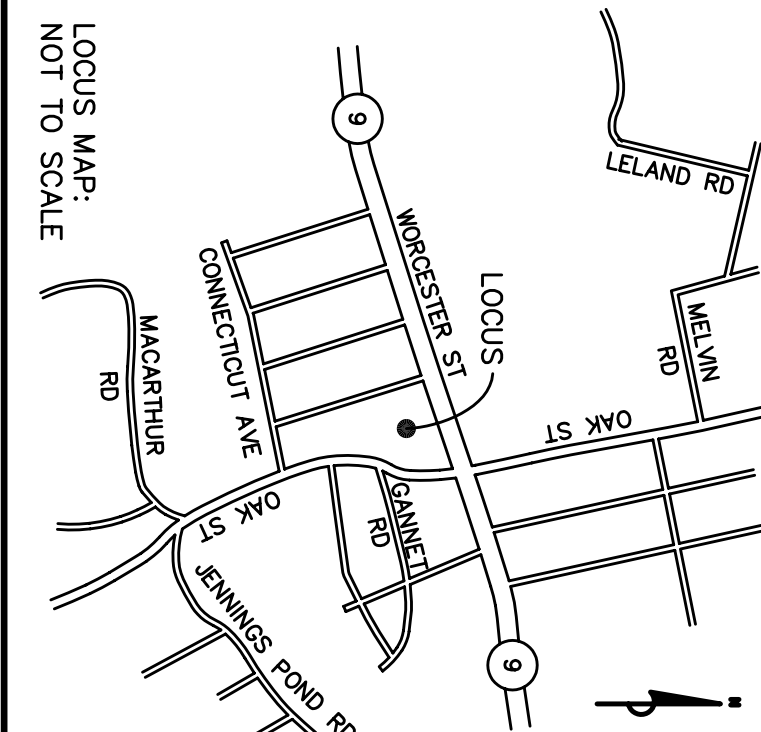

OWNER:  
RHODE ISLAND AVENUE  
INHABITANTS OF THE TOWN OF NATICK  
ASSESSORS PARCEL 21-00000159

EXHIBIT PLAN OF  
RHODE ISLAND AVENUE  
IN  
**NATICK, MA**  
(MIDDLESEX COUNTY)  
SCALE: 1" = 20' DATE: JANUARY 21, 2022

**PLS**  
Precision Land Surveying, Inc.  
32 Turnpike Road  
Southborough, Massachusetts 01772  
TEL NO: (508) 460-1789 FAX NO:(508) 970-0096  
476801PL1.DWG

# Rhode Island Ave Orientation (2016)

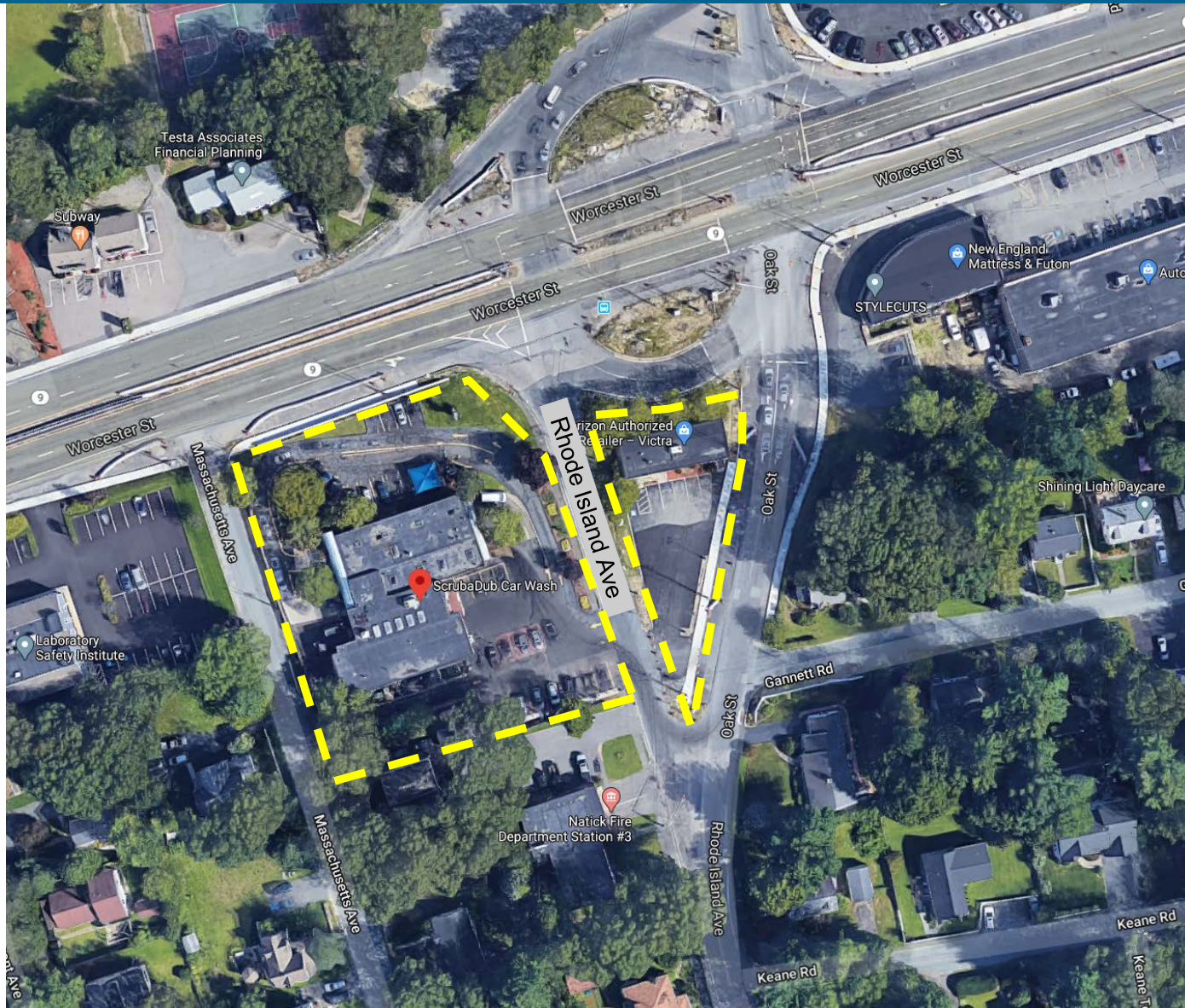

# Conceptual Improvement Plan – Rhode Island Ave

